

# THE 53' CONVERTIBLE. FOR VIKING, A NEW LENGTH. FOR BOATING, A NEW HEIGHT.



VIKING 53'  
CONVERTIBLE

 **viking**  
yachts



HER SHARP ENTRY AND FLARED BOW GIVE THE 53'  
HER UNCOMMONLY SOFT, DRY RIDE.

It's been said that man-made forms don't evolve. The Viking 53' Convertible refutes that premise; she's the logical extension of a quarter century of design refinement. In this case, the Darwinian lab is offshore sportfishing itself.

The challenge to the designer of a modern convertible is really a question of balance. The design objective is to build a stable, fast, sure-footed yacht capable of over-the-horizon fishing forays.

But, when the fish don't want to play the game, the design objective is to furnish a civilized, impeccably turned-out interior to entertain and enjoy the company of family or fishing buddies. If you investigate Viking's new 53' Convertible, you'll find that both pursuits are securely covered.

When the tournament begins, it's survival of the fittest (and the fastest). Viking's engineers and craftsmen use a host of advanced procedures and materials to build a very special yacht. The one that will get you there first, let you fish longer once there, and get you back in comfort—swiftly and safely. It's nice to reflect on the fact that thousands of Viking convertibles have been earning this reputation over a quarter century.

**“THE 53' VIKING USES EVERY  
HIGH-TECH TRICK IN THE BOOK.”**

—Boating Magazine

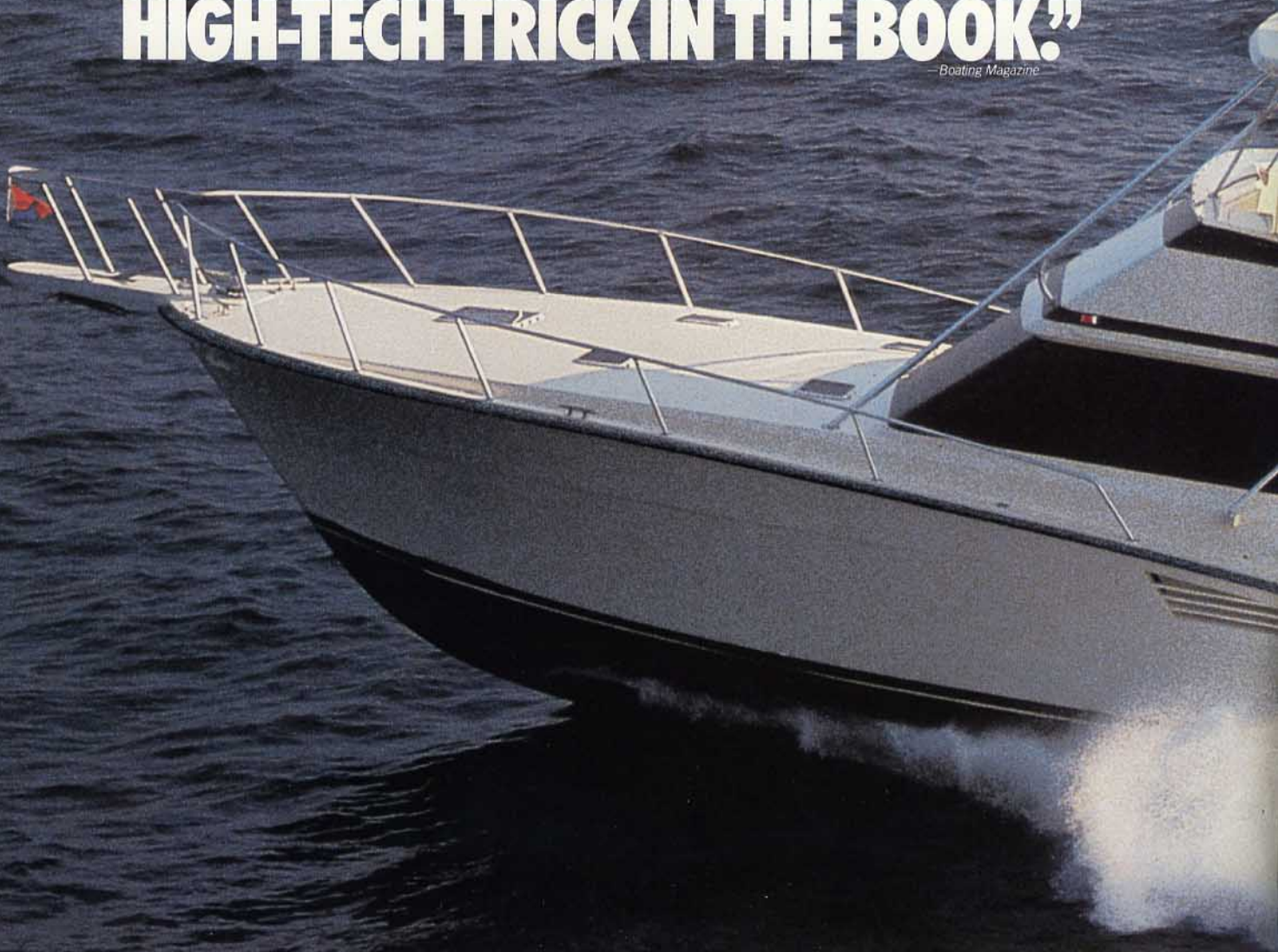

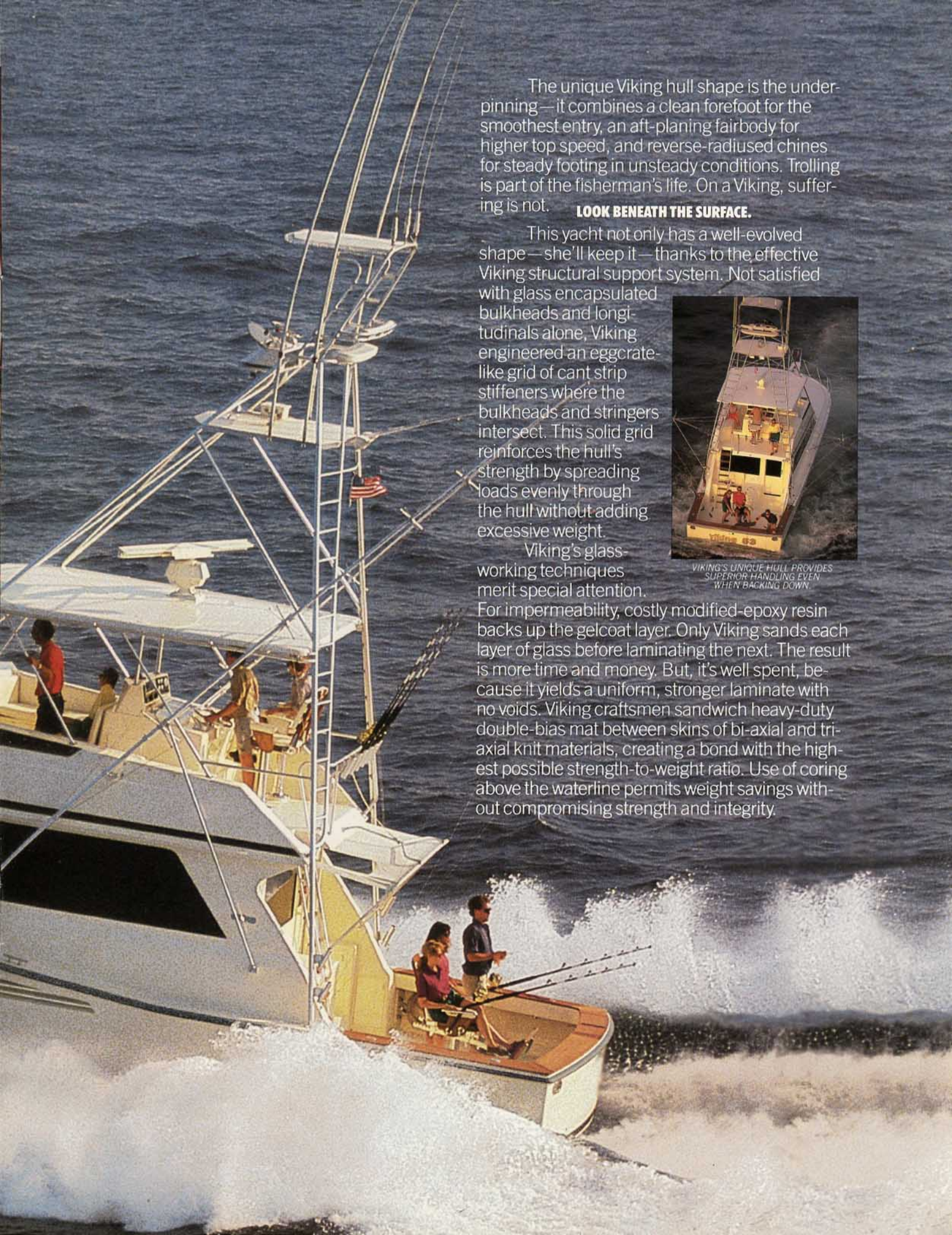

The unique Viking hull shape is the underpinning — it combines a clean forefoot for the smoothest entry, an aft-planing fairbody for higher top speed, and reverse-radiused chines for steady footing in unsteady conditions. Trolling is part of the fisherman's life. On a Viking, suffering is not.

**LOOK BENEATH THE SURFACE.**

This yacht not only has a well-evolved shape — she'll keep it — thanks to the effective Viking structural support system. Not satisfied with glass encapsulated bulkheads and longitudinals alone, Viking engineered an eggcrate-like grid of cant strip stiffeners where the bulkheads and stringers intersect. This solid grid reinforces the hull's strength by spreading loads evenly through the hull without adding excessive weight.

Viking's glass working techniques merit special attention. For impermeability, costly modified-epoxy resin backs up the gelcoat layer. Only Viking sands each layer of glass before laminating the next. The result is more time and money. But, it's well spent, because it yields a uniform, stronger laminate with no voids. Viking craftsmen sandwich heavy-duty double-bias mat between skins of bi-axial and tri-axial knit materials, creating a bond with the highest possible strength-to-weight ratio. Use of coring above the waterline permits weight savings without compromising strength and integrity.



*VIKING'S UNIQUE HULL PROVIDES SUPERIOR HANDLING EVEN WHEN BACKING DOWN.*

The clean design of the 151 square foot, all business, fishing-ready cockpit evinces Viking's long practice of fishing what they build. Because you're definitely going to fish this boat, a 29" transom door, 6-foot recessed fishwell, molded-in tackle cabinet with freezer, bait prep area with sink, rod holders and washdowns are essential and therefore standard. This cockpit is designed to work hard and stay beautiful.

Unlike other boats, the bow pulpit back through the cockpit liner is one unitized assembly. No seams, no leaks, no squeaks. Sound level in the cockpit is greatly attenuated by Viking's placement of all noise-making machinery (engines, generators, mufflers) in the sound-deadened engine room, not under the cockpit sole.



PLENTY OF ROOM FOR FLUSH-MOUNTED ELECTRONICS GIVE THE 53' THAT CUSTOM-HELM LOOK.

#### **THE TOTAL COMMAND STATION.**

To cap off a professional fishing machine, Viking provides a professional bridge. The 53's helm includes a multi-function systems monitor, a flat area for chartwork and plenty of panel space for integrating flush-mounted plotters, fish-finders and radar displays.

It's hard to improve on this yacht, but the optional hardtop enhances the 53' by providing a semi-enclosed bridge and overhead integrated electronics box. This expansive bridge also provides preferred, up-top seating for ten guests. Secure, large-diameter grabrails surround the bridge and a venturi windshield reduces buffeting.

Whether your aim is to stalk big game fish, to entertain big fish clients, or simply to engage in some relaxed cruising with family and friends, this yacht will do it with a maximum of style.

#### **THE BLUE-RIBBON ENGINE ROOM.**

To harness the 53's incredible power, each engine is mounted to a pair of wide, flanged steel beams, which, in turn, are fastened to dedicated bulkheads, fore and aft. On competing boats, engines are mounted to longitudinal stringers, which can flex, causing premature shaft and drivetrain wear.

A fully loaded, tower-rigged 53' powered by twin MAN 2840LXE turbo-diesels, was radar-clocked by *Boating* magazine at a top speed



**IF YOU CAN'T CATCH FISH  
ON THIS BOAT,  
SHE'S PROBABLY SITTING  
AT THE DOCK.**



of 33 knots, with a calculated cruising range at 1800rpm (25.2 knots) of 394 nautical miles.

The test's editor, Dex Hart, gave the 53's cockpit entry, stand up and walk around engine room, "... my blue



COCKPIT ENTRY AND TRUE WALK-AROUND ACCESS EARNED THIS ENGINE ROOM BOATING'S "BLUE RIBBON"

ribbon for convertibles, with the easiest access I've found." Engine room mechanicals include a carefully organized systems layout and a full set of optional monitoring gauges on each engine. Advanced sound-deadening engineering includes a six-inch-thick composite sole over the engine room.

As part of what has been described as "fanatical attention to detail," Viking builds virtually the entire boat in-house (excluding appliances).

# "NO-COMPROMISE QUALITY AND RELIGIOUS ATTENTION TO DETAIL!"

—Boating Magazine



THE LIVING ROOM-SIZED SALON CATERS TO ENTERTAINING ON A GRAND SCALE.



RECESSED APPLIANCES MAKE THE FULLY-EQUIPPED GALLEY BLEND IN BEAUTIFULLY WITH THE SALON AND DINETTE.



THE PORT GUEST STATEROOM: TWO MAN-SIZED BUNKS PLUS PLENTY OF DRAWER AND HANGING STORAGE.



THE FULL-SIZED FORWARD HEAD IS ACCESSIBLE FROM THE FORWARD STATEROOM AND COMPANIONWAY.



ITS LARGE HATCH HELPS MAKE THE COMFORTABLE FORWARD STATEROOM BRIGHT AND AIRY.



Slide open the roomy companionway and immerse yourself in the inner world of the Viking 53', cooled by three separate zones of powerful air conditioning.

The generous 16'7" beam allows the salon, dinette and galley to be placed all on the same level. Viking craftsmen hand fashion all the interior cabinetry from select fitches of rich Burmess teak. Built-in accoutrements include an L-shaped lounge (with convertible bed), a wetbar, complete audio and video entertainment center and the ship's electrical panels with digital voltage readouts.

The contemporary galley with teak parquet floor is inset forward of the salon to port, behind an attractive, yet functional service island which houses the refrigerator and optional trash compactor or dishwasher. All the conveniences, from the convertible rangetop/ countertop to a convection/microwave oven are right at hand or can be concealed when not in use.

**THE HEART OF THE 53' IS ITS MID-SHIP MASTER SUITE.**

The opulent, midship master suite is thoughtfully placed at the point of least motion and elegantly appointed with a complete



*A DOUBLE WALK-AROUND QUEEN SIZED BED FIT FOR A KING.*

entertainment center, vanity and a walk-around queen-sized bed. A generous cedar-lined hanging locker, a substantial bureau and ample wardrobe space are provided, of course, as is the adjoining private head.

The two guest staterooms each feature plenty of stowage space and a man-sized pair of upper and lower bunks. The elegant portside head with companionway access also is a private head for the forward guestroom.

The 53's sumptuous interior is the crowning touch of a new standard for luxury and performance. This magnificent sportfishing yacht amply proves that after 25 years, Viking remains a generation ahead.



*THE MASTER HEAD PAMPERS YOU IN COMPLETE PRIVACY.*

# VIKING 53' CONVERTIBLE

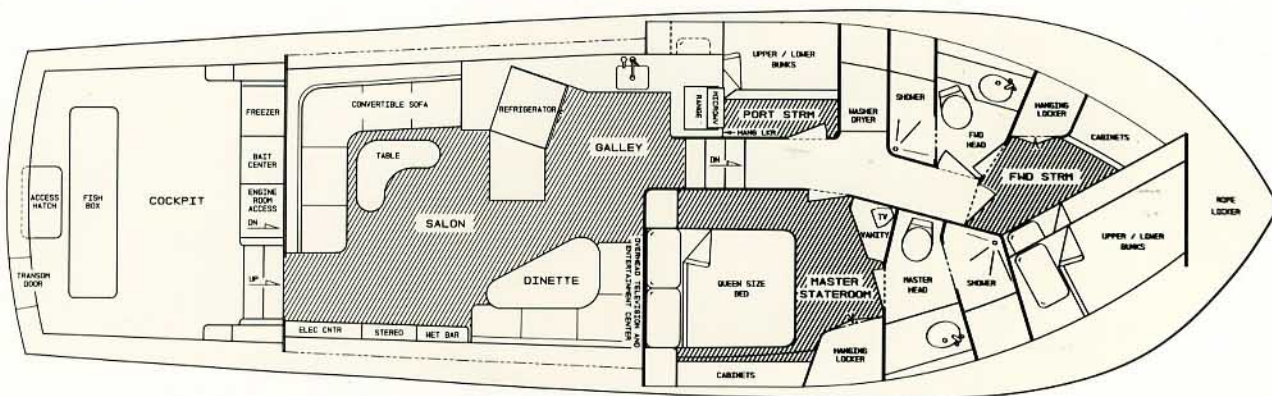

**viking**  
yachts  
*For those who know better.*

Route 9 and The Garden State Parkway, New Gretna, NJ 08224, Tel: (609) 296-6000, Fax: (609) 296-3956